



*jordan fishwick*

7 Dixon Court, SK8 1DE  
Guide Price £189,950



## Dixon Court Cheadle SK8 1DE

Guide Price £189,950



**\*\*NO CHAIN\*\*** Spacious Two Double Bedroom Apartment in the Heart of Cheadle Village - With Garage. This well-presented two double bedroom second floor apartment offers spacious accommodation tucked away privately behind a parade of shops, the property enjoys a quiet yet highly convenient location within easy walking distance of local amenities, restaurants, cafes and transport links. The accommodation briefly comprises a modern fitted kitchen with integrated fridge freezer, cooker with hob, extractor fan and washing machine. The property features a bright and spacious open-plan kitchen/lounge and dining area, with doors leading out to a private south-facing balcony, providing an ideal space to relax. There are two generously sized double bedrooms and a modern bathroom suite complete with a separate shower cubicle. Must view!



- 2 Double Bedrooms
- Open Plan Kitchen/Living/Dining
- Gas Central Heating
- Cheadle High St Location
- Garage



Energy Efficiency Rating		
	Current	Potential
Very energy efficient - lower running costs		
(92 plus) <b>A</b>		
(81-91) <b>B</b>		
(69-80) <b>C</b>		
(55-68) <b>D</b>		
(39-54) <b>E</b>		
(21-38) <b>F</b>		
(1-20) <b>G</b>		
Not energy efficient - higher running costs		
<b>England &amp; Wales</b>	EU Directive 2002/91/EC	

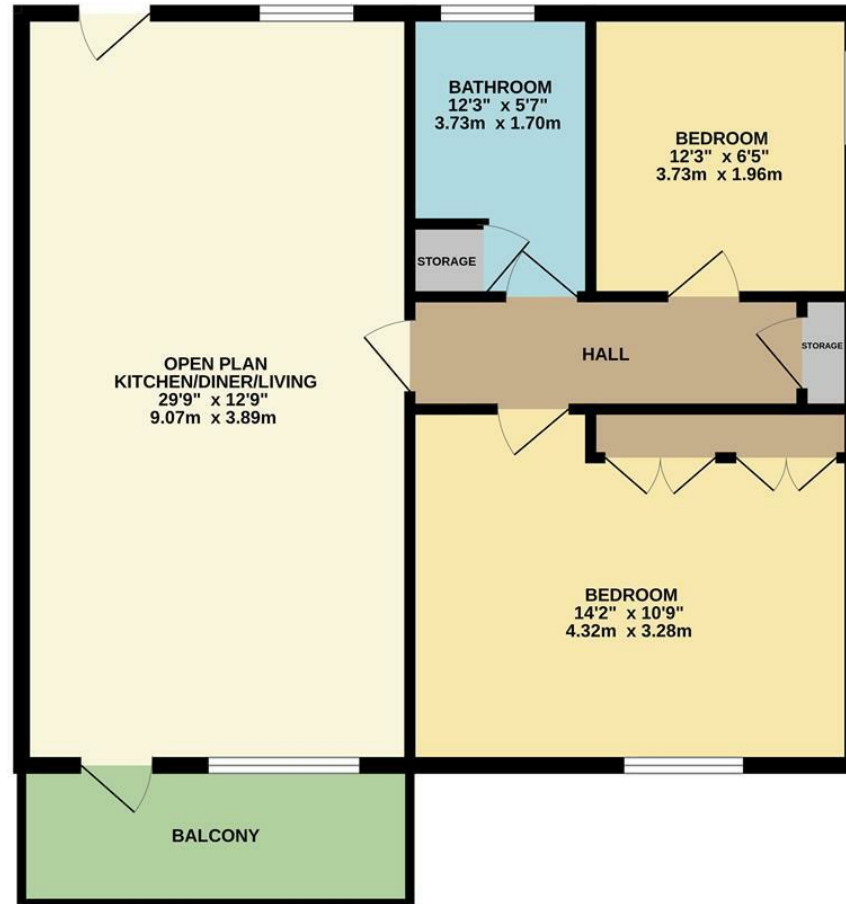

Measurements are approximate. Not to scale. Illustrative purposes only.  
Made with Metropix ©2025



These particulars are believed to be accurate but they are not guaranteed and do not form a contract. Neither Jordan Fishwick nor the vendor or lessor accept any responsibility in respect of these particulars, which are not intended to be statements or representations of fact and any intending purchaser or lessee must satisfy himself by inspection or otherwise as to the correctness of each of the statements contained in these particulars. Any floorplans on this brochure are for illustrative purposes only and are not necessarily to scale.

Offices at: Chorlton, Didsbury, Disley, Hale, Glossop, Macclesfield, Manchester Deansgate, Manchester Whitworth Street, New Mills, Sale, Wilmslow and Withington

36-38 Alderley Road, Wilmslow SK91JX  
**01625 532000**

wilmslow@jordanfishwick.co.uk  
www.jordanfishwick.co.uk